

PG series SMD type & 125°C Guaranteed



Features

- ◆ SMD type .
- ◆ 125°C Guaranteed

Specifications

Item	Performance Characteristics	
Operating Temperature Range	-55°C ~ +125°C	
Rated Voltage Range	6.3~50V DC	
Capacitance Range	10 to 1500 μF	
Capacitance Tolerance	±20% (120Hz , +20°C)	
Leakage Current (+20°C, max.)	Not to exceed the values shown in Standard Ratings (Rated voltage applied, after 2 minutes at 20°C)	
Dissipation Factor (tan δ , at 20°C , 120Hz)	Not to exceed the values shown in Standard Ratings	
ESR (at 100KHz , 20°C)	Not to exceed the values shown in Standard Ratings	
Endurance 125°C , 2000h , at rated voltage	Capacitance Change	Within ±20% of the value before test
	Leakage current	Not to exceed the value specified
	ESR	Not to exceed 150% of the value specified
	Dissipation Factor	Not to exceed 150% of the value specified
Moisture Resistance Stored at 60°C , RH90~95% , 1000h	Capacitance Change	Within ±20% of the value before test
	Leakage current	Not to exceed the value specified
	ESR	Not to exceed 150% of the value specified
	Dissipation Factor	Not to exceed 150% of the value specified

Frequency Coefficient for Ripple Current

Frequency	120Hz ≤ freq. < 1KHz	1KHz ≤ freq. < 10KHz	10KHz ≤ freq. < 100KHz	100KHz ≤ freq. < 300KHz
Coefficient	0.05	0.3	0.7	1

Recommended land pattern:(unit:mm)

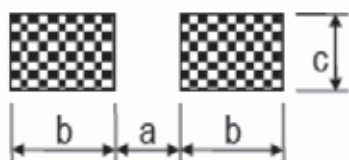

φ DxL	a	b	c
6.3x5.8	2.1	3.5	1.6
6.3x7.7	2.1	3.5	1.6
8x7.7	2.8	4.2	1.9
8x8.7	2.8	4.2	1.9
8x11.7	2.8	4.2	1.9
10x8.7	4.3	4.4	1.9
10x10.5	4.3	4.4	1.9
10x12.4	4.3	4.4	1.9

Diagram of Dimensions:(unit:mm)

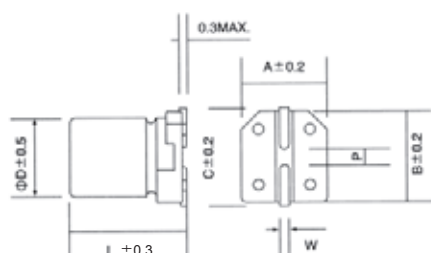

φ DxL	W	H	C	R	P
6.3x5.8	6.5	6.5	7.2	0.5 to 0.8	2.2
6.3x7.7	6.5	6.5	7.2	0.5 to 0.8	2.2
8x7.7	8.3	8.3	9.0	0.7 to 1.1	3.1
8x8.7	8.3	8.3	9.0	0.7 to 1.1	3.1
8x11.7	8.3	8.3	9.0	0.7 to 1.1	3.1
10x8.7	10.3	10.3	11.0	0.7 to 1.1	4.5
10x10.5	10.3	10.3	11.0	0.7 to 1.1	4.5
10x12.4	10.3	10.3	11.0	0.7 to 1.1	4.5

Standard Ratings

W.V. (V)	Cap(μF)	Size φ DxL(mm)	L.C. (μA,2min)	tg δ (120Hz,20°C)	ESR (mΩ),100KHz)	Rated Ripple Current		Allowable Ripple Current	
						100KHz (mA,r.m.s)			
						105°C < Tx≤125°C		Tx≤105°C	
6.3	100	6.3x5.8	300	0.08	35	695	2200		
	270	6.3x7.7	340.2	0.08	25	885	2800		
	470	8x7.7	592.2	0.08	25	1100	3500		
	820	8x11.7	1033.2	0.08	15	1490	4700		
	1000	10x10.5	1260	0.08	18	1390	4400		
	1500	10x12.4	1890	0.08	15	1610	5100		
10	56	6.3x5.8	300	0.08	35	695	2200		
	120	6.3x7.7	300	0.08	25	885	2800		
	150	6.3x7.7	300	0.08	25	885	2800		
	180	6.3x7.7	360	0.08	25	885	2800		
	270	8x7.7	540	0.08	25	950	3000		
	330	10x8.7	660	0.08	25	1100	3500		
	470	8x11.7	940	0.08	15	1330	4200		
	560	10x10.5	1120	0.08	18	1265	4000		
16	820	10x12.4	1640	0.08	15	1420	4500		
	47	6.3x5.8	400	0.10	50	505	1600		
	82	6.3x7.7	400	0.10	30	695	2200		
	100	6.3x7.7	400	0.10	30	695	2200		
	120	8x7.7	400	0.12	30	885	2800		
	150	8x8.7	480	0.12	28	950	3000		
		10x8.7	480	0.12	35	930	3000		
	180	8x11.7	576	0.12	20	1200	3800		
		10x8.7	576	0.12	35	930	3000		
	220	8x11.7	704	0.12	20	1200	3800		
	270	10x10.5	864	0.12	25	1105	3500		
	330	10x10.5	1056	0.12	25	1105	3500		
	390	10x12.4	1248	0.12	20	1265	4000		
	560	10x12.4	1792	0.12	20	1265	4000		
20	22	6.3x5.8	600	0.10	50	505	1600		
	33	6.3x5.8	600	0.10	50	505	1600		
	47	6.3x7.7	600	0.10	35	695	2200		
	56	6.3x7.7	600	0.10	35	695	2200		
	68	6.3x7.7	600	0.10	35	695	2200		
	82	8x7.7	600	0.12	35	885	2800		
	120	8x7.7	600	0.12	35	885	2800		
	150	8x11.7	600	0.12	25	1200	3800		
	180	8x11.7	720	0.12	25	1200	3800		
		10x10.5	720	0.12	27	1105	3500		
	220	10x10.5	880	0.12	27	1105	3500		
	330	10x12.4	1320	0.12	25	1265	4000		
25	10	6.3x5.8	600	0.10	60	474	1500		
	22	6.3x5.8	600	0.10	60	474	1500		
	39	6.3x7.7	600	0.10	35	695	2200		
	47	6.3x7.7	600	0.10	35	695	2200		
	47	8x11.7	600	0.12	25	1100	3500		
	56	8x7.7	600	0.12	35	885	2800		
	68	8x7.7	600	0.12	35	885	2800		
		8x11.7	600	0.12	25	1200	3800		
	82	8x8.7	600	0.12	30	950	3000		
		8x11.7	600	0.12	25	1200	3800		
	100	10x8.7	600	0.12	35	885	2800		
		8x11.7	600	0.12	25	1200	3800		
	120	8x11.7	600	0.12	25	1200	3800		
		10x10.5	600	0.12	27	1105	3500		
	150	10x12.4	750	0.12	25	1265	4000		
	180	10x12.4	900	0.12	25	1265	4000		

Ripple Current(mA,rms)at 125°C, 100KHz

W.V. (V)	Cap(μF)	Size φ DxL(mm)	L.C. (μA,2min)	tg δ (120Hz,20°C)	ESR (mΩ),100KHz)	Rated Ripple Current		Allowable Ripple Current	
						100KHz (mA,r.m.s)			
						105°C < Tx≤125°C		Tx≤105°C	
35	10	6.3x5.8	600	0.12	75	310		980	
	18	6.3x7.7	600	0.12	60	450		1400	
	22	8x11.7	600	0.12	35	730		2300	
	27	6.3x7.7	600	0.12	60	450		1400	
	33	8x11.7	600	0.12	35	730		2300	
	39	8x8.7	600	0.12	40	570		1800	
	56	8x11.7	600	0.12	35	730		2300	
	68	10x10.5	600	0.12	32	800		2500	
	100	10x10.5	700	0.12	32	800		2500	
		10x12.4	700	0.12	30	980		3100	
	150	8x11.7	1050	0.12	25	1650		4800	
180	10x10.5	1260	0.12	30	1390		4400		
50	10	8x7.7	100	0.12	75	450		1400	
	12	6.3x7.7	120	0.12	75	450		1400	
	22	8x8.7	220	0.12	50	570		1800	
		8x11.7	220	0.12	40	760		2400	
		10x8.7	220	0.12	55	570		1800	
	27	8x11.7	270	0.12	40	760		2400	
	33	10x10.5	330	0.12	42	700		2200	
		10x12.4	330	0.12	30	885		2800	
	47	10x12.4	470	0.12	30	885		2800	
	100	10x12.4	1000	0.12	30	885		2800	
	180	10x12.4	1800	0.12	24	950		3000	

Ripple Current(mA,rms)at 125°C, 100KHz